

TIGHTENING HITCH PIN WITH LOCK



Model #25219

- Note** The locking and tightening hitch pin is designed for use with 2" hollow ball mounts or hitch mounted accessories only.
- Note** If this product is left on the receiver for long periods of time, the bolt may loosen slightly. Periodically check the tightness of the bolt and tighten if necessary.
- Note** A quality lock lubricant (preferably with graphite) is recommended for use at least once a year to best maintain the functionality of the lock. Simply add the lubricant to where the key enters the lock.

PARTS INCLUDED

- (A) Stainless Steel Lock Bolt
- (B) Lock Washer
- (C) Square 5/8" Nut
- (D) Nut Holder
- (E) Nut Holder Adapter
- (F) Brass Lock with Dust Cover

TOOLS REQUIRED

7/8" (21mm) Wrench

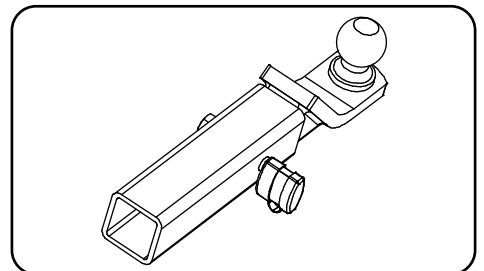
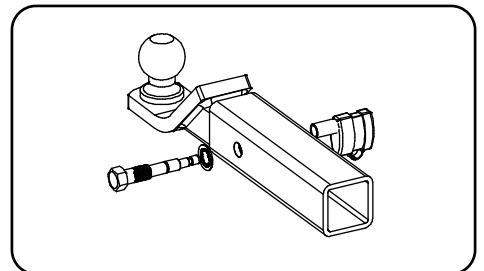
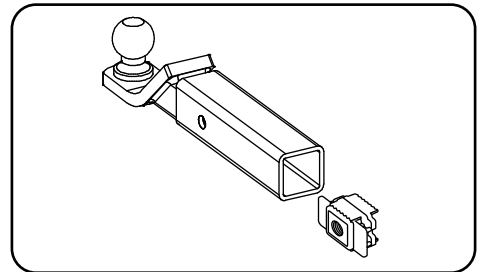
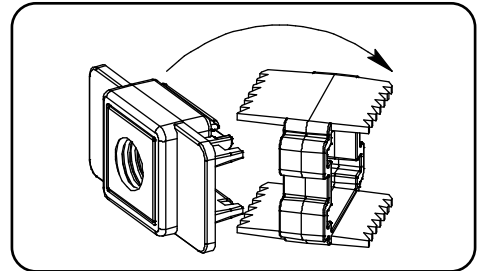
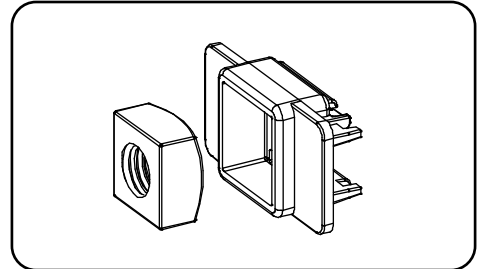
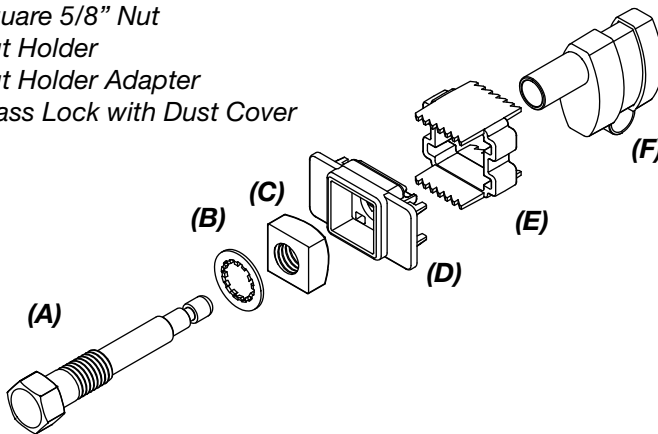

Assembly Instructions

1. Place square nut (item C) in the nut holder (item D).
2. Fit the nut holder into the nut adapter (item E). The adapter can be rotated 180° for variances in wall thickness of the ball mount or receiver mounted equipment.
3. Fit the nut holder assembly into the ball mount until the threaded nut lines up with the side hole in the ball mount.
4. Slide the ball mount into the receiver until the holes line up.
5. Place the lock washer on the bolt and slide the bolt through the holes. Hand tighten.
6. Place the lock over the opposite end of the bolt (making sure it is engaged) and place the dust cap over the key hole.
7. Use a 7/8" (21mm) wrench to tighten the bolt head to no more than 60ft. lbs.
8. Periodically check the tightness of the bolt to ensure it is secure.



LIMITED LIFETIME WARRANTY

Access Racks™ & QuietRide™ Towing Accessories

Softride, Inc., warrants the original owner of new Softride Access Racks™ and QuietRide™ Towing Accessory products against defects in workmanship and materials for the lifetime of the product provided it is purchased from an authorized Softride dealer. This Limited Lifetime Warranty is non-transferable and shall only apply to normal and ordinary use of this product.

Warranty claims are to be made through an authorized Softride dealer and must be accompanied by an original sales receipt or other original proof of purchase document. Registration of your product can be completed by filling out the online form at www.softride.com/warranty-information and must be received by Softride before warranty claims may be processed. Should any Softride Access Rack™ or QuietRide™ towing accessory be determined by Softride to be defective and covered by this Limited Lifetime Warranty, it will be repaired or replaced, at Softride's option. The cost of transportation to and from an authorized dealer for repair or replacement, of any defective part, and/or accessory and any related labor charge is not covered by this warranty, and is to be paid by the owner.

The Limited Lifetime Warranty does not cover normal wear and tear (including and not limited to: scratches, dents, fading, oxidation), improper assembly, lack of maintenance, or custom alteration/installation of any parts or accessories not originally intended or compatible with the rack or towing accessory as sold. The warranty does not apply to damage or failure resulting from an accident, abuse, or neglect. This Limited Lifetime Warranty does not cover racks that are mounted on the back of a trailer.

This Limited Lifetime Warranty is given in lieu of all other written or oral warranties, express warranties, implied warranties, registered product, including without limitation implied warranties of merchandising ability and fitness for a particular purpose, and are limited to the duration and specifications of this warranty. In no event shall Softride be liable for damage in excess of the purchase price, for any loss of use, loss of time, inconvenience, commercial loss, lost profits, or saving or any incidental, special, consequential, direct or indirect damages arising out of the use or inability to use such product, to the full extent as such may be disclaimed by law.

Log onto www.softride.com/warranty-information to register your product.

©Copyright 2008 Softride, Inc. Softride, QuietRide™ and Access Racks™ are registered trademarks of Softride, Inc. Bellingham, WA 98226 USA